



\$259,900

1618 S. Taylor Circle

PLAN 1717



Every Artistic Home Features:

- LEED Certified
- Energy Star Certified
- HERS Index of 0-57
- Averages 43% more energy efficient than a "code" build home
- Includes Air Conditioning
- Whole house HEPA filtration system.
- Includes Landscaping
- 2 yr system/10 year structural warranty from 2/10 home buyer warranty, Inc.

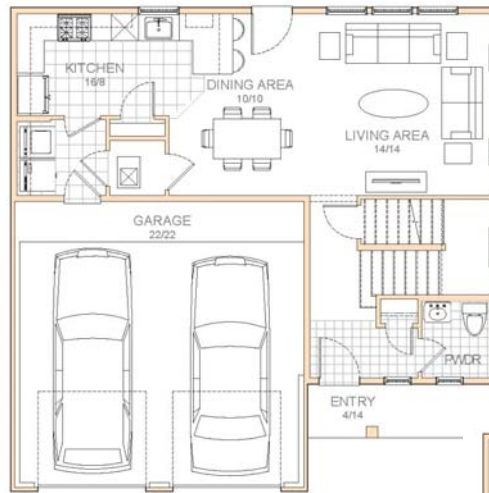

First Floor

Plan 1717
36'x36'

**MLS #
643675**



Second Floor

Plan 1717
36'x36'

DIRECTIONS TO SALES OFFICE:

FROM HWY 160 (BAYFIELD) TURN LEFT ON CR 501. GO 1.1 MILES NORTH AND LOOK FOR DOVE RANCH SIGNS TURN RIGHT. MAKE THE FIRST LEFT ON TAYLOR CIRCLE GO .1 MILES TO AUTO COURT. LOOK FOR OPEN HOUSE SIGNS.



1717 Sq. Ft.
\$259,900

BUILDING GREEN

Thanks to advanced design, engineering and construction techniques, Artistic Homes has added a home heating and cooling cost guarantee.

Artistic Homes guarantees an air tight construction on all their homes. The heating ducts are located in conditioned space to allow for an un-interrupted blanket of insulation in the attic.

Every home is sized, sealed and insulated and leak tested. With a room to room pressure balanced system, Artistic Homes guarantees no more than 3 degrees temperature difference in living to provide maximum comfort.

**CALL OR STOP
BY TODAY**

**TO LEARN MORE ABOUT
THESE HIGH
PERFORMANCE, AWARD
WINNING 100% LEED-H
HOMES**

JUST SOME OF THE MANY DETAILS:

- Bedrooms: 3
- Bathrooms: 2.5
- Heat: Forced Air 95% Eff. Gas Furnace
- Cooling: Refrigerated Air
- Air Quality: Whole House High Efficiency Air Filtration System with Room Pressure Balanced System
- Windows: ANDERSON Energy Star Rated Low E with Argon Gas Blend
- Insulation: GREEN GUARD R50 in Ceiling, R21 in Walls

AVAILABLE OPTIONAL PACKAGES:

Plumbing, Appliances, Lighting, Flooring, Accent Walls, Solar Packages, Exterior stone, Shingles and Stucco Color.

FOR MORE INFORMATION CONTACT:

DOVE RANCH SALES OFFICE

970.884.5102

OR

GINA MC CORMICK

970.403.6116

www.DOVERANCH.com